

Sample Loading Protocol for nCounter *SPRINT*[™] Profiler

Materials:

- nCounter *SPRINT* Cartridge
- RNase-free water or hybridization buffer
- P100 or P200 pipette with filter tips
- KimWipe or similar lint-free wipes

Protocol:

1. Remove cartridge from -20°C and equilibrate to room temperature for 15 minutes.
2. Remove hybridized samples from the thermocycler; do not let samples remain at room temperature for longer than 15 minutes before initializing a run.
3. Briefly spin down hybridized samples.
4. Bring sample volume to 30 µL with RNase-free water or hybridization buffer.
5. Load 30-35 µL of each sample into the cartridge. Maximum cartridge volume is 35 µL for each lane.
6. Hold pipette perpendicular to cartridge, insert the tip into the loading port:

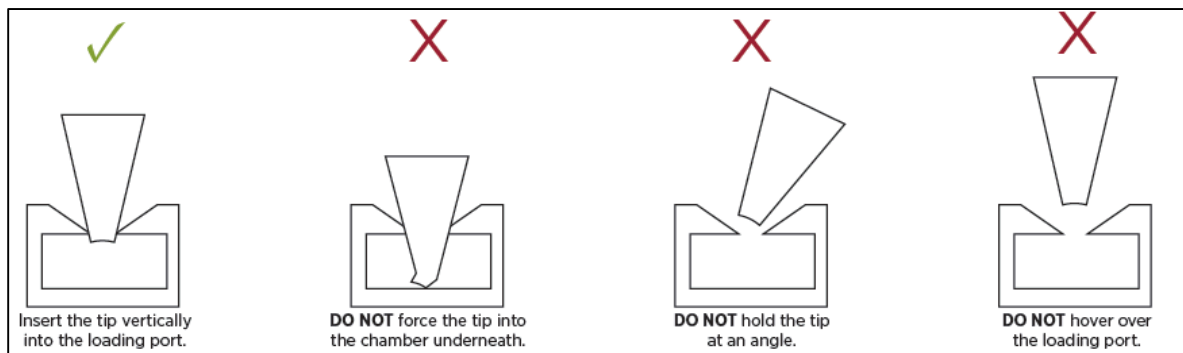

7. Depress the plunger to the second stop, creating an air bubble.
8. Remove the pipette from the cartridge BEFORE releasing the plunger.
9. Load 30 µL water for empty lanes with no samples.
10. Wipe away excess liquid from the surface of the cartridge with a KimWipe or similar lint-free wipe.
11. Apply transparent seal over the sample loading ports.
12. Visually inspect that there are no empty lanes and loading ports have been sealed with tape.
13. Remove protective green seal from the reagent ports.
14. Take your cartridge to the instrument and place the cartridge into the cartridge drawer. Ensure the cartridge is aligned in the proper orientation and fully seated in the cartridge tray.
15. Start your run.